



AVENTOS HK-S

Technical data sheet

www.blum.com

 **blum**[®]

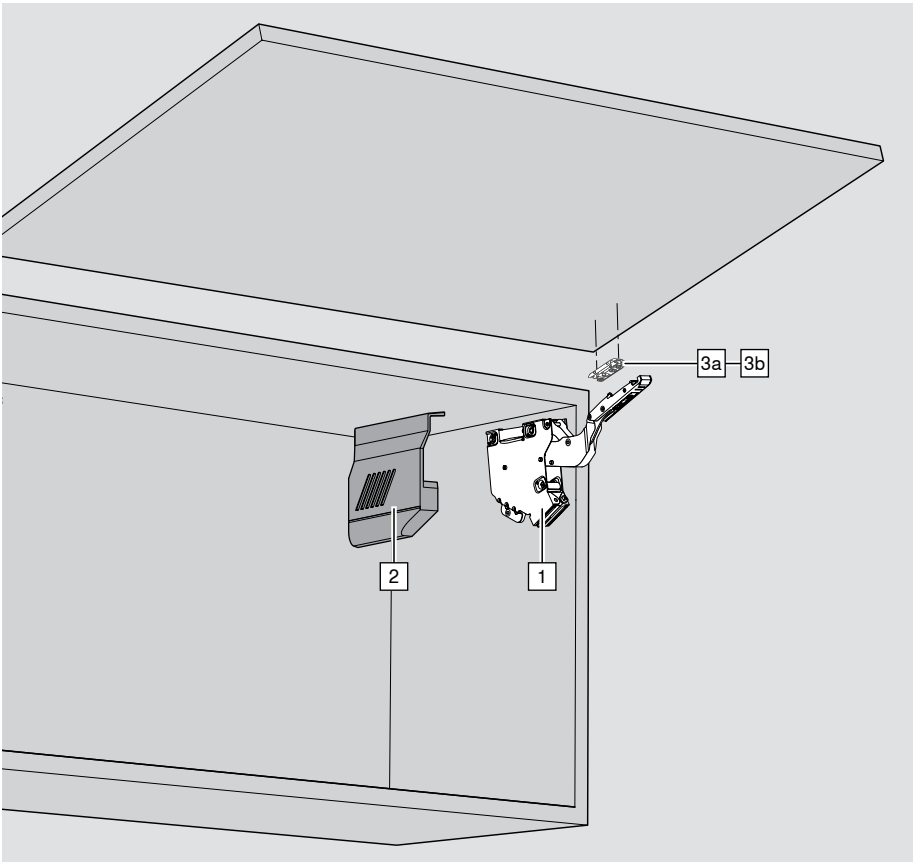

- Ideal for low cabinet heights in the wall units, and the top frontals in appliance housings (over ovens, fridges etc).
- Cabinet heights up to max. 600 mm
- Cabinet width depends on the power factor
- Silent and effortless closing, thanks to BLUMOTION
- Light operating forces
- Perfect comfort of motion with a variable stop
- Simple, tool-free assembly
- 3-dimensional adjustment of the front
- Simple, variable lift mechanism
- No hinges required

i

This is how it's done: Power factor = cabinet height (KH) [mm] x door weight including double the handle weight [kg]

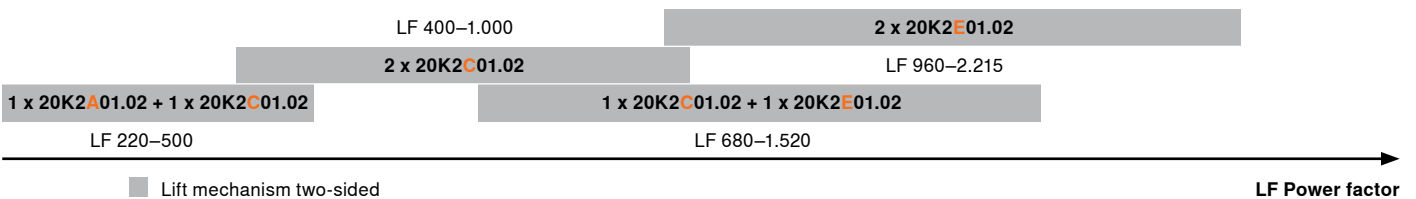

A trial application is recommended when you are in a borderline area of the individual lift mechanism.

1	Lift mechanism symmetrical			
	Spring	Opening angle		
	none	107°	2 x	20K2A01.02
	weak	107°	2 x	20K2C01.02
	strong	107°	2 x	20K2E01.02
	Combinations		LF	
	2 x 20K2A01.02			not possible
	1 x 20K2A01.02	1 x 20K2C01.02		220 – 500
	2 x 20K2C01.02			400 – 1.000
	1 x 20K2C01.02	1 x 20K2E01.02		680 – 1.520
	2 x 20K2E01.02			960 – 2.215

AVENTOS HK-S





Order specification

2	Cover cap	
	Nylon light grey, silk white	
	left/right	20K8A01

		Opening angle stop	
	Nylon		
	100° deep grey	2 x	20K7A41
	75° dust grey	2 x	20K7A11

3a	Front fixing brackets	
	Nickel plated steel	
	Wooden fronts and wide alu frames ¹⁾	2 x 175H3100

		Bit PZ cross slot	
	size 2, length 39 mm		BIT-PZ KS2

3b	Front fixing brackets	
	Nickel plated steel	
	Narrow alu frames	left/right 20K4A01A01

¹⁾ Use 2 chipboard screws (609.1x00) for wooden fronts. Use 2 self tapping screw, countersunk head (660.0950) for wide alu frames.

Peg positions for lift mechanism

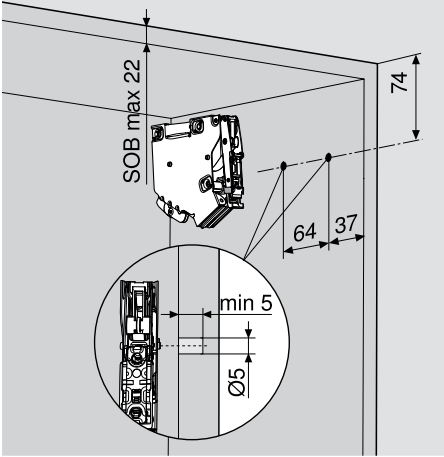

SOB Top panel thickness

Fixing positions for lift mechanism

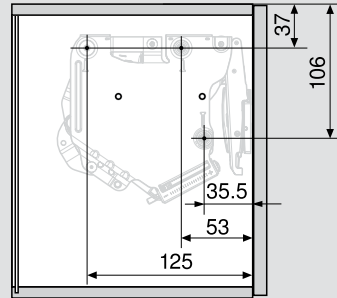

3 x Ø 4 x 35 mm

Space requirement

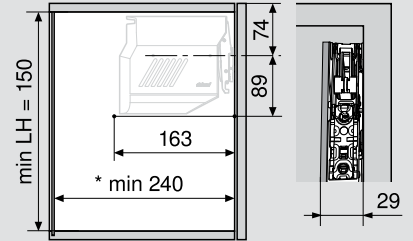

* Min. 240 mm with visible wall hanging bracket

Maximum cabinet height 600 mm

Front assembly

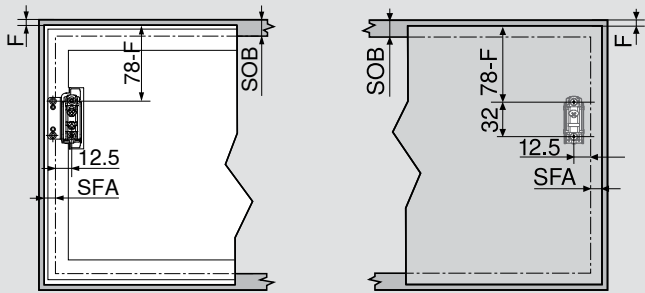

Narrow alu frames

Wooden fronts and wide alu frames¹⁾

Wall application:
requires 5 mm min. gap

Ø 3.5 x 15 mm

F Gap

SFA Side front overlay

SOB Top panel thickness

Planning narrow alu frames

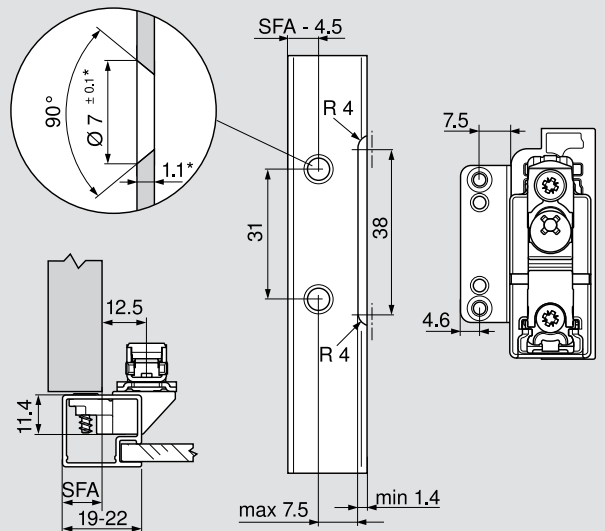

SFA Side front overlay

For frame frieze width 19 mm:
SFA of 11–18 mm possible

* When changing material thickness, adjust the assembly dimensions accordingly

¹⁾ Use 2 chipboard screws (609.1x00) for wooden fronts. Use 2 self tapping screw, countersunk head (660.0950) for wide alu frames.

AVENTOS HK-S



Planning

Cornice and crown moulding clearance

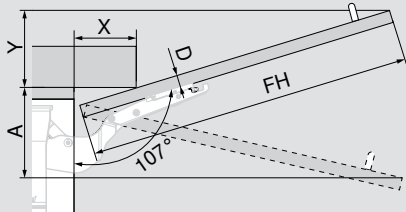

D (mm)	16	19	22	26
X (mm)	70	59	49	35

Without OEB $Y = FH \times 0.29 - 15 + D$

OEB 100° $Y = FH \times 0.17 - 15 + D$

OEB 75° $A = FH \times 0.26 + 15 - D$

OEB Opening angle stop

Min. Gap

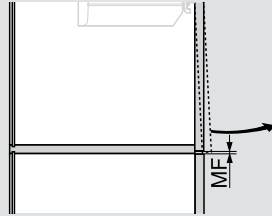

MF Minimum gap for opening (2 mm)

Cabinet assembly

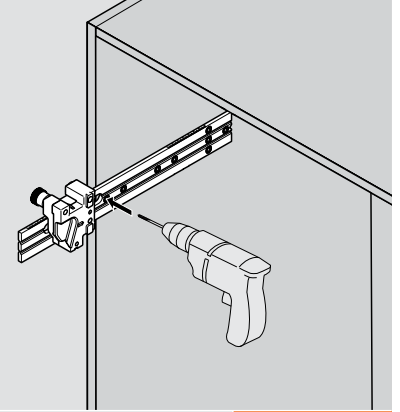

Drilling template

65.1051.01

applicable for all lift systems

Julius Blum GmbH
Furniture Fittings Mfg.
6973 Höchst, Austria
Tel.: +43 5578 705-0
Fax: +43 5578 705-44
E-mail: info@blum.com
www.blum.com

